

MONUMENT RECORD
State of Indiana - County of Monroe

Section: 7 Township: 8 North Range: 1 East Corner ID: SaCr C-07

Monument Description & Remarks: Sandstone with "X", length 0.63ft, width 0.38ft, height 0.38ft. Survey Sign 4ft above ground at pt. B

References On File: Legal Survey Book 2 page 470 survey (1889), on file in Surveyor Office; Eric Lee Deckard survey, Moravec Boundary (2001), on file in Auditor Office and Surveyor Office

RECOVERY TIE DRAWING
Field Book 40 Page No. 05

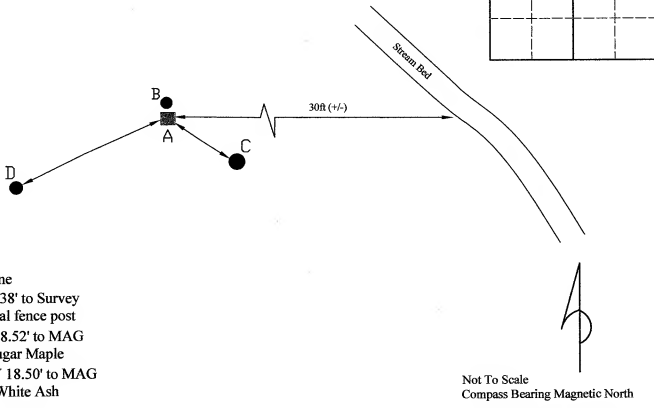

- A - Sandstone
- B - North 0.38' to Survey Sign on metal fence post
- C - S 46° E 8.52' to MAG nail in 8" Sugar Maple
- D - S 74° W 18.50' to MAG nail in 13" White Ash

Not To Scale
Compass Bearing Magnetic North

I, Kevin P. Enright, Monroe County Surveyor, hereby certify that this document was prepared under my direction in accordance with the provisions of sections 2-12-11 of the Indiana Code, and the above data is given under my hand and seal this 4th day of October, 2007.

Kevin P. Enright



Administered by the Monroe County Surveyor

Date: 11-13-2007